

What the

BEST DRESSED



Drive-thru is Wearing

131 BI-PARTING SLIDING WINDOW

The 131 Bi-Parting Window is the perfect enhancement to the drive-thru concept, offering unobstructed views of customer and crew.

This attractive and economical window is ideal for a drive-thru or walk up application. The large service opening is suitable for both large and small operations. It is available in two standard window heights, 37 3/4" H and 43 3/4" H.



PRODUCT DESCRIPTIONS

- **Manual Self Closing or Electric Openings**

The 131 Bi-Parting Slider keeps building costs down by offering the window in a manual operating style. Or for those who experience heavier traffic, an electric operating style is also available. Electric models meet health department requirements for self-closing units.

- **Ease of Operation**

In a manual operation, the inside attendant pulls the door handle, and both doors part from the center to either side. With a fully automated operation, the operator simply steps into the presence sensor and the movable window panels slide open. When the operator steps out of the presence sensor, the movable window panels automatically close. The range for the presence sensor is adjustable. To specific customer needs.

- **Adjustable Service Opening**

Operators can easily adjust the window for two convenient opening sizes at any given time. By simply pressing a button the doors will open to either 12"W or 18"W serving area.

- **Quality Construction**

Anodized aluminum extrusions, stainless steel and 1/4" tempered glass combine to give you an attractive window that not only enhances building exteriors, but will not rust, pit or weather. Track free bottom sill provides for a contaminant free surface.

- **Double Security Locks**

The 131 Bi-Parting Slider automatically locks each time the window closes, providing security when the window is left unattended. When the drive-thru is closed, manual security locks help prevent outside entry.

- **Fully Assembled, Ready to Install**

Ready Access windows are shipped completely preassembled, and fully glazed for lower installation costs. Normal installation takes less than two hours.

- **Warranty and Service Support**

Your Ready Access window comes with a one year limited warranty on parts and labor provided by a worldwide service organization.

- **AVAILABLE OPTIONS**

The 131 Bi-Parting Slider is available in statuary bronze or clear anodized aluminum.

2 standard window dimensions available:

131: 53 1/2"W x 37 3/4"H (18"W x 31"H service opening)

131-6: 53 1/2"W x 43 3/4"H (18"W x 37"H service opening).

A stainless steel shelf is also available.

- **CUSTOM OPTIONS**

- Custom heights are available in both self closing and electric operations.

- Tinted glass is available upon request.

- Powder coat painting is available in a wide range of custom colors.

ARRIVES READY FOR INSTALLATION

Your Ready Access window is shipped completely assembled and ready for installation. Comes with instructions.

131 FLUSHMOUNT BI-PARTING WINDOW

Manual operation or Fully-automatic operation

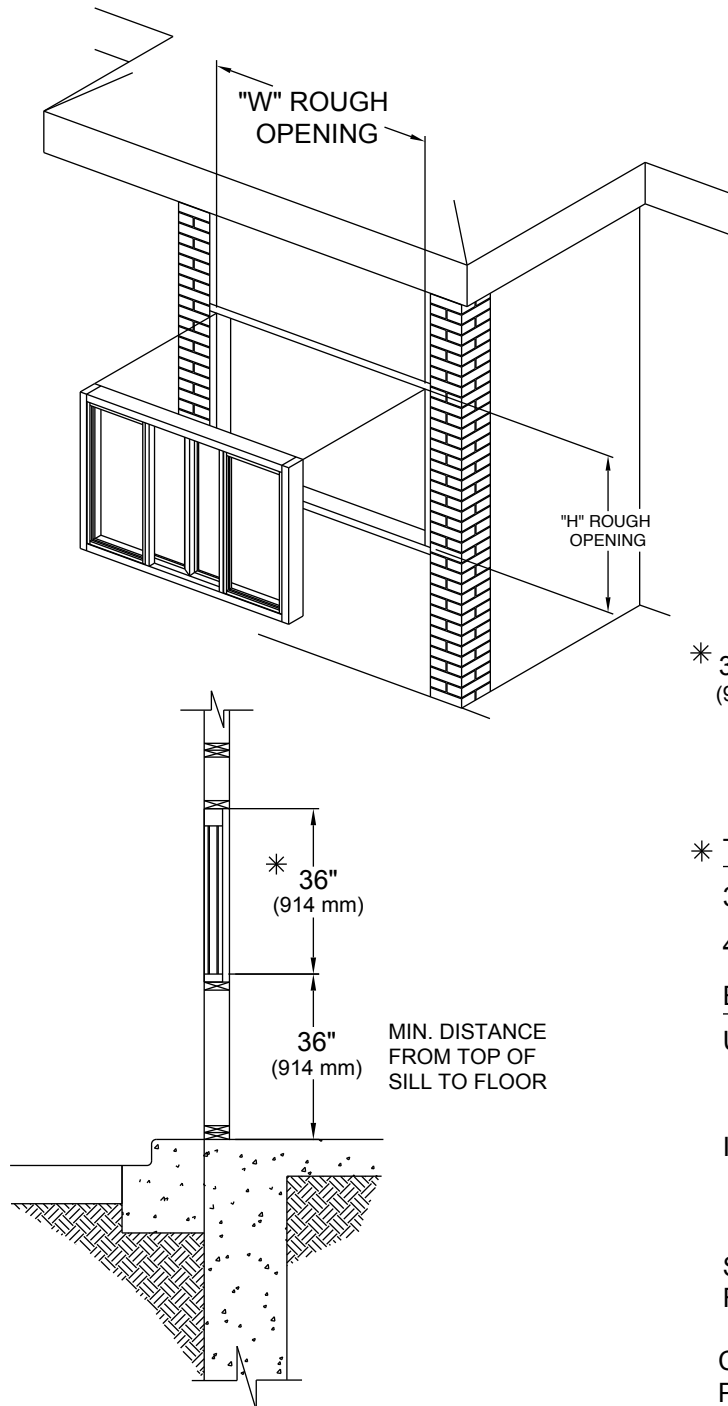

131 - 53-1/2"W x 37-3/4"H

Glazing Rough Opening =
53-3/4"W (1365 mm) x 38"H (965 mm)
Masonry Rough Opening =
54"W (1372 mm) x 38-1/4"H (972 mm)

131-6 - 53-1/2"W x 43-3/4"H

Glazing Rough Opening =
53-3/4"W (1365 mm) x 44"H (1118 mm)
Masonry Rough Opening =
54"W (1372 mm) x 44-1/4"H (1124 mm)

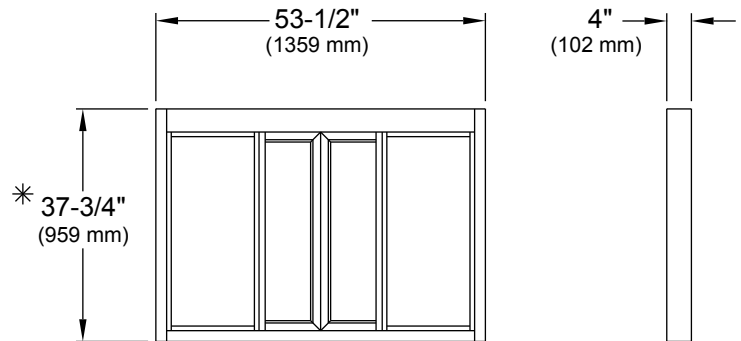

* TWO STANDARD WINDOW HEIGHTS

37-3/4" H WITH 18"W x 31"H SERVICE OPENING

43-3/4" H WITH 18"W x 37"H SERVICE OPENING

ELECTRICAL REQUIREMENTS

USA (DOMESTIC) : 115 vac - 60 Hz
WITH A 15 amp
BRANCH CIRCUIT

INTERNATIONAL : 220/240 vac - 50/60 Hz
WITH A MAX. 8 amp
BRANCH CIRCUIT

SERVICE OPENING ADJUSTS TO 12"W
FROM THE PUSH OF A BUTTON.

Custom sizes and colors available.
Please contact Ready Access for more information.

Window must be installed square and plumb.

Installation illustrations are for reference only. Construction
and local codes will determine proper installation of window.

Contact Ready Access for more information on installation.

