

4

3

2

1



OUTSIDE VIEW SHOWN

79.5

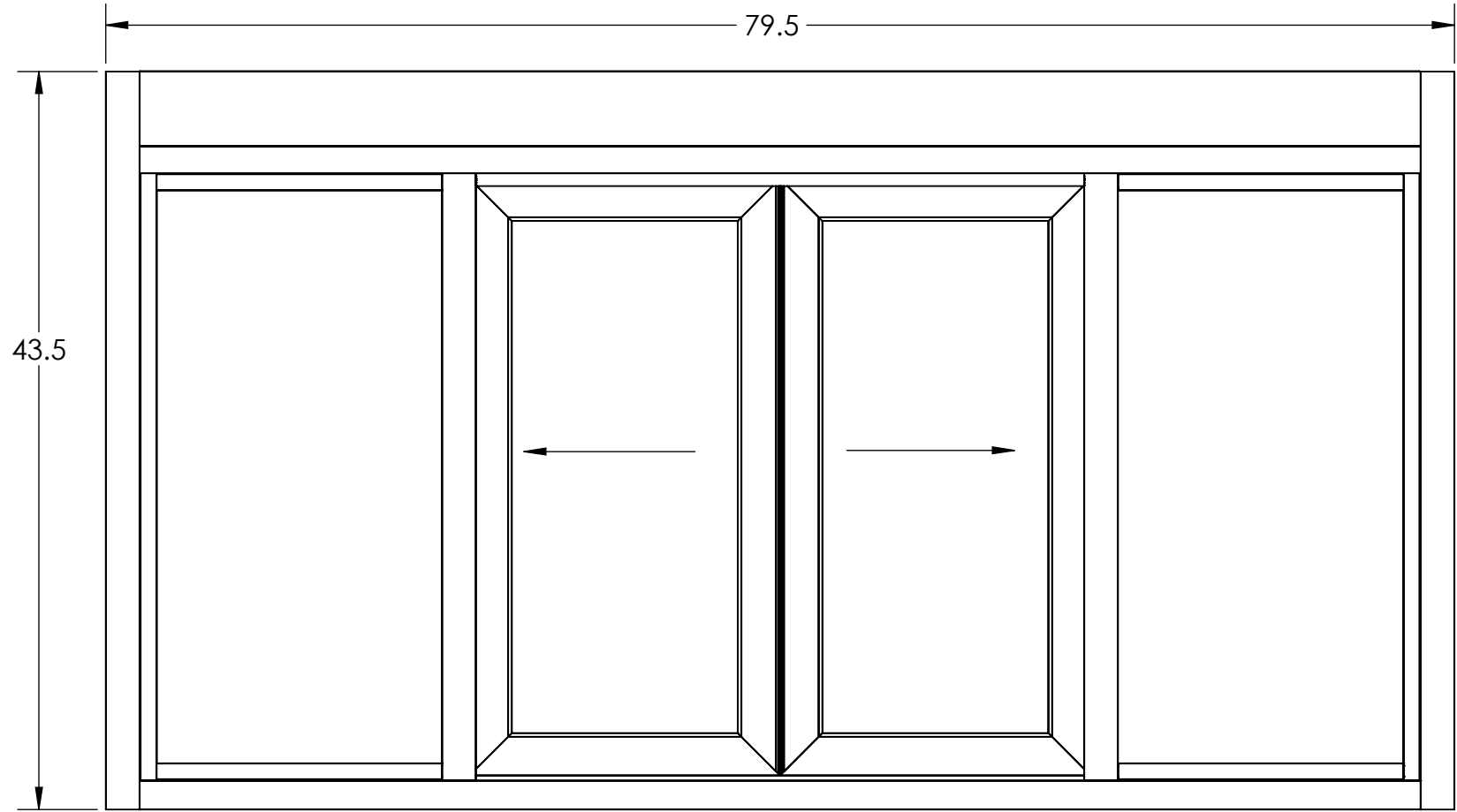

43.5

CUSTOMER APPROVAL SIGNATURE

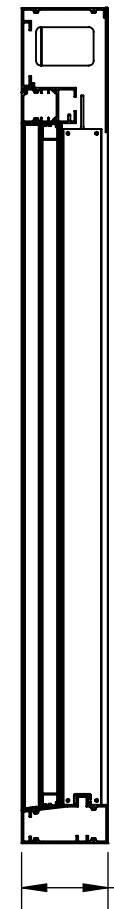

4.5

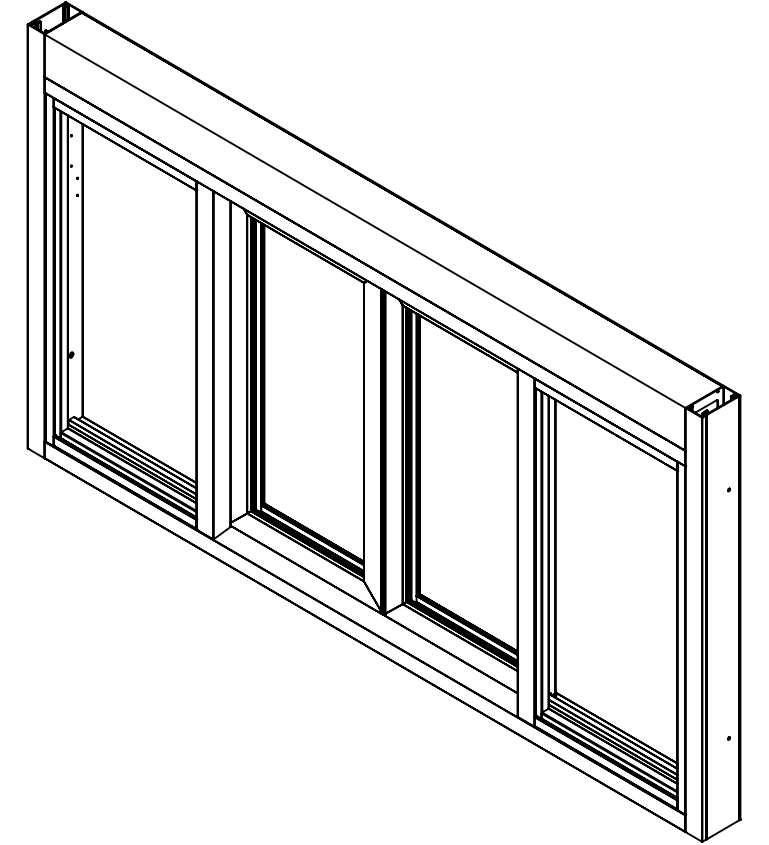

READY ACCESS MODEL 606-80
 OVERALL SIZE 79.5" W X 43.5" H
 ROUGH OPENING 80"W X 44" H
 SERVICE OPENING 34" W X 34.75"H BI PARTING SLIDING WINDOWS
 3/4" INSULATED SOLARBAN 70XL GLAZING
 OPERATION: SELF-CLOSE
 FINISH: DARK BRONZE ANODIZE

WORK TO DIMENSIONS- DO NOT SCALE
 TOL. UNLESS SPECIFIED
 XXXX TOL. NOT REQD
 TOL. CLASS ± .063
 ANGULAR TOL. ± 1°

USED IN PRODUCTS:
 REVISION: A
 REVISION DATE:

DESIGN BY: BCG
 DATE: 11/4/2025
 DRAWN BY: BCG
 DATE: 11/4/2025

MATERIAL: ALUM.
 MATERIAL SPEC:
 GAUGE:



1815 Arthur Drive, West Chicago, Illinois 60185. 800-621-5045. 630-876-7766. Fax 630-878-7767

LATEST REVISION NOTE:
 REV = A RELEASE FOR CUSTOMER APPROVAL

DESCRIPTION: 606-80

PART NO.: 606-80

4

3

2

1

B

B

A

A

4

3

2

1

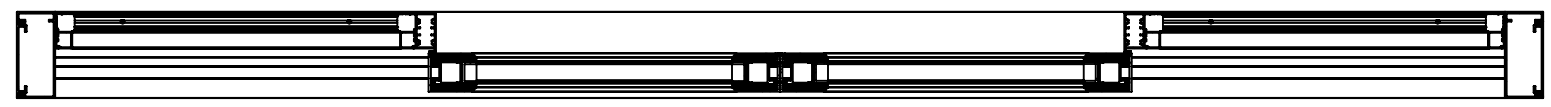

INSIDE VIEW SHOWN

79.5

43.5

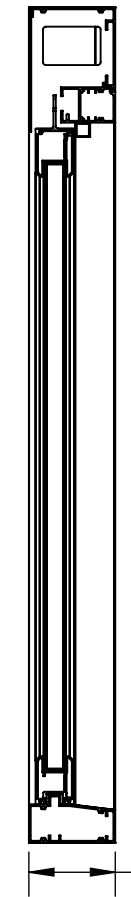
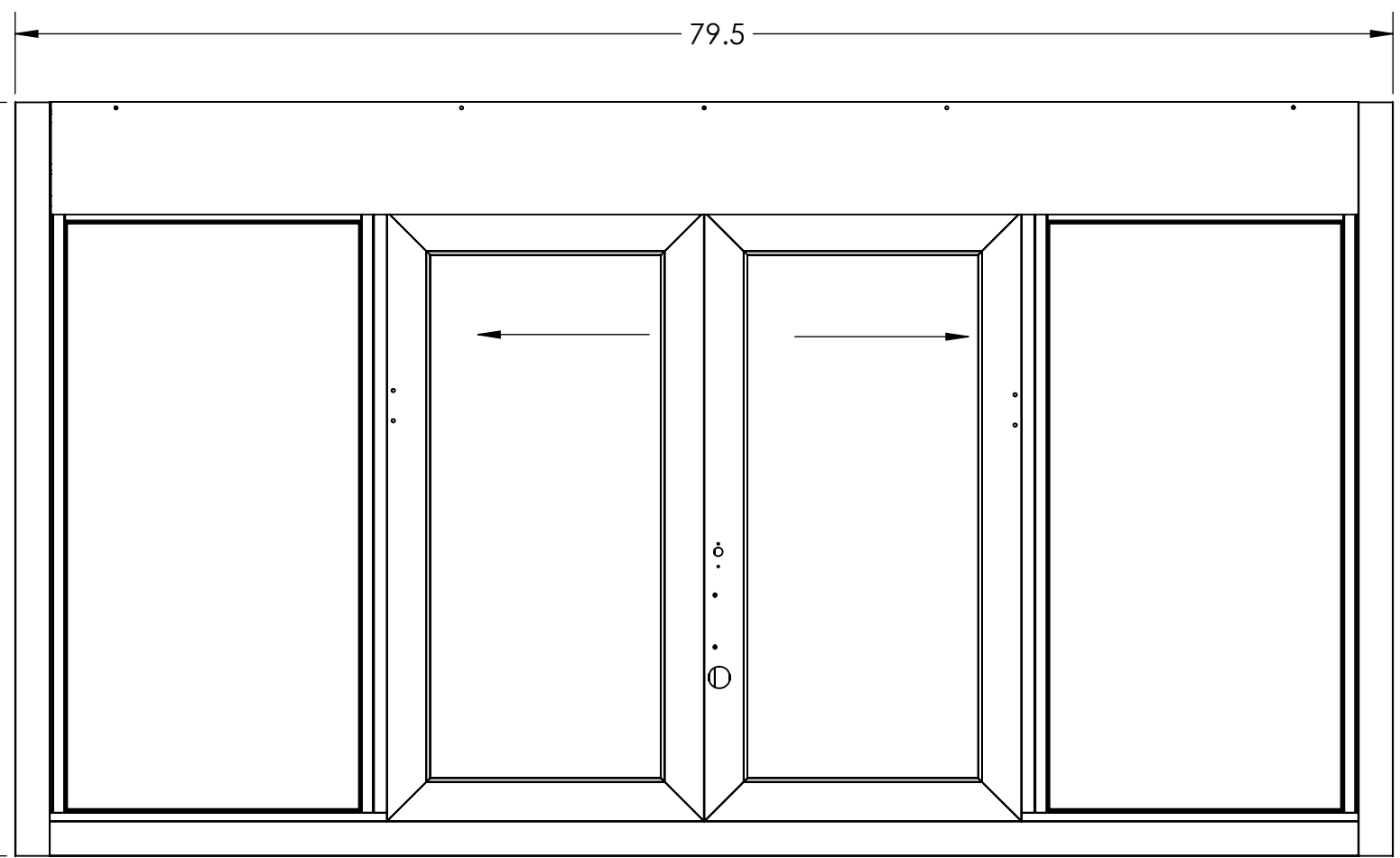

4.5

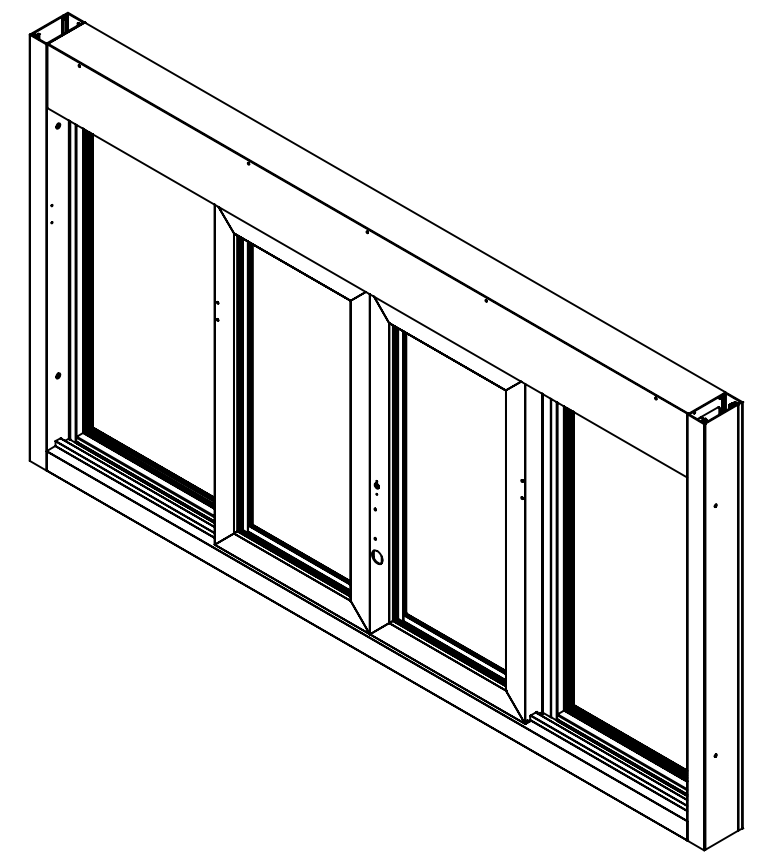

CUSTOMER APPROVAL SIGNATURE

READY ACCESS MODEL 606-80
 OVERALL SIZE 79.5" W X 43.5" H
 ROUGH OPENING 80"W X 44" H
 SERVICE OPENING 34" W X 34.75"H BI PARTING SLIDING WINDOWS
 3/4" INSULATED SOLARBAN 70XL GLAZING
 OPERATION: SELF-CLOSE
 FINISH: DARK BRONZE ANODIZE

WORK TO DIMENSIONS- DO NOT SCALE
 TOL. UNLESS SPECIFIED
 XXXX TOL. NOT REQD
 TOL. CLASS ± .063
 ANGULAR TOL. ± 1°

USED IN PRODUCTS:
 REVISION: A
 REVISION DATE:

DESIGN BY: BCG
 DATE: 11/4/2025
 DRAWN BY: BCG
 DATE: 11/4/2025

MATERIAL: ALUM.
 MATERIAL SPEC:
 GAUGE:



1815 Arthur Drive, West Chicago, Illinois 60185. 800-621-5045. 630-876-7766. Fax 630-878-7767

LATEST REVISION NOTE:
 REV = A RELEASE FOR CUSTOMER APPROVAL

DESCRIPTION: 606-80
 PART NO.: 606-80

4

3

2

1

B

B

A

A