



INSTALLATION INSTRUCTIONS

**MOUNTING BRACKET FOR USE WITH READY ACCESS PASS THROUGH WINDOW AND AIR CURTAIN
RAC-22 AND RAC-E22 AND RELAY SWITCH KITS**

SUITABLE FOR WALL AND OR TRANSOM MOUNT APPLICATIONS

***FOR COMMERCIAL OR INDUSTRIAL USE ONLY**

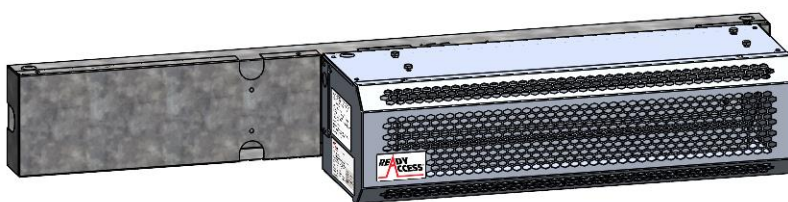

(RAC-22 Air Curtain not included)

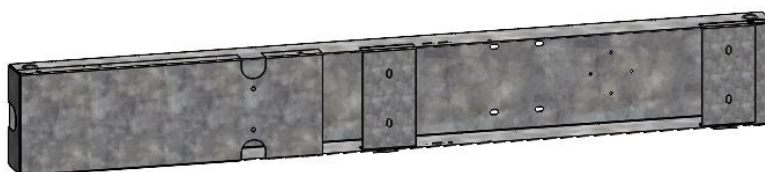

MOUNTING BRACKET ASSEMBLY

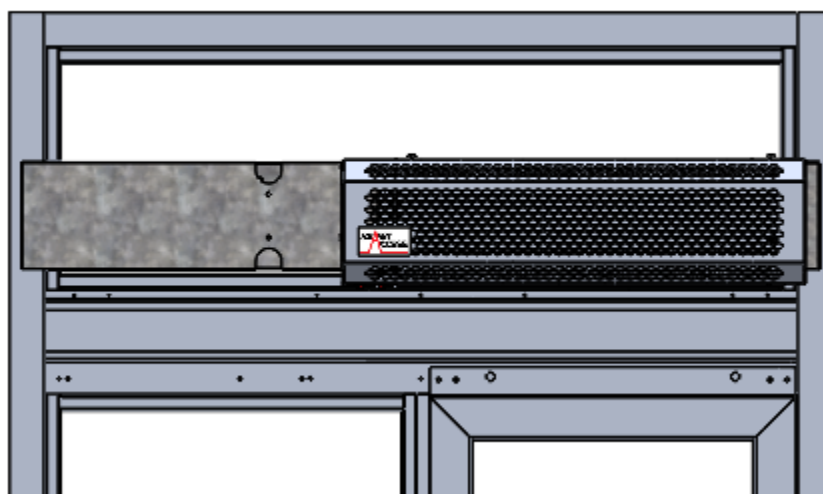

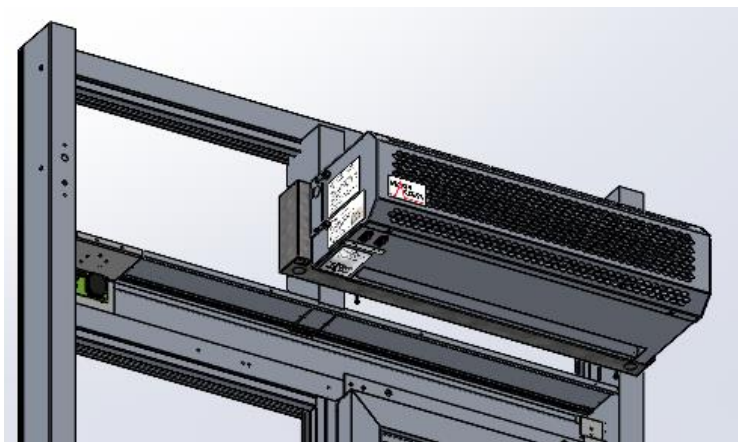

(RAC-22 Air Curtain not included)

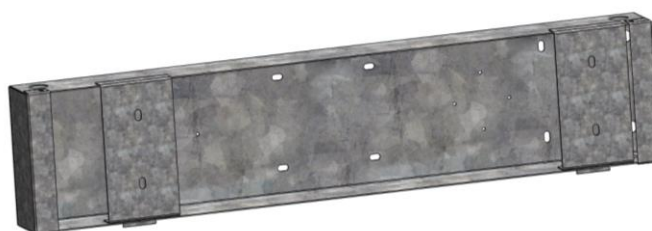

SMALL MOUNTING BRACKET ASSEMBLY

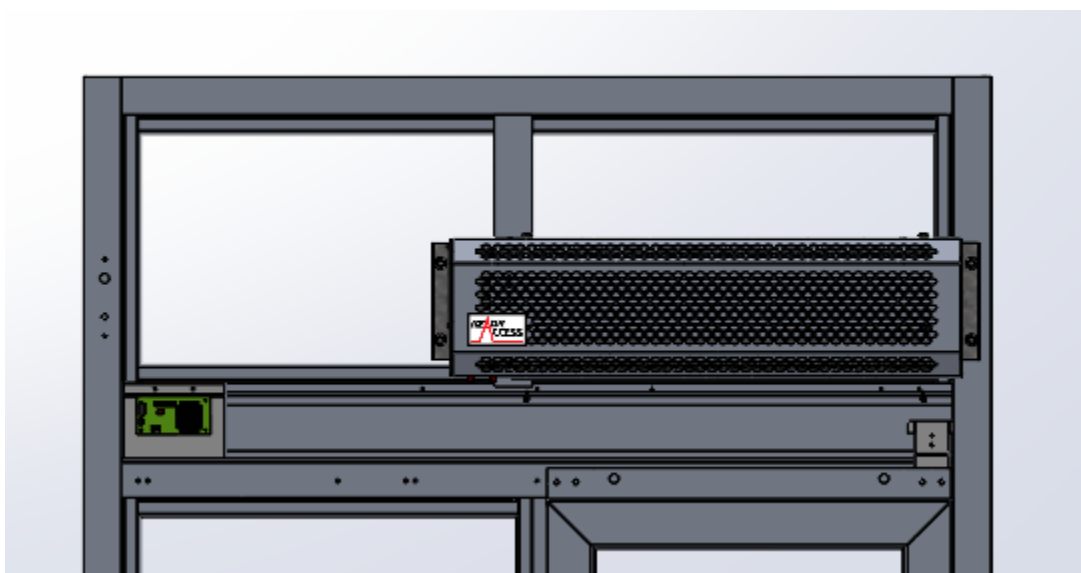

Refer to RAC-22 installation manual for installation of the RAC-22 AIR CURTAIN. Refer to the RELAY KIT instructions for installation and wiring of the RELAY KIT.

Read and save these instructions. Read carefully and completely before attempting to install or operate this device. Failure to comply with these instructions could result in injury, damage to the unit or installation site.



NOTICE: Indicates an instruction which, if not followed, could result in damage to product or property or poor product performance.



WARNING: Indicates an instruction which, if not followed, could result in minor or moderate injury.

TABLE OF CONTENTS

1. INTRODUCTION
2. SAFETY INFORMATION
3. INSTALLATION
4. OPTIONAL RELAY KIT INSTALLATION

1. INTRODUCTION

Ready Access Air Curtains are designed to provide an environmental barrier between the indoor environment and the outdoor, exterior environment. The Ready-Access air curtain provides temperature control, environmental separation, and control of flying insects. The RAC-22 and RAC-E22 are recommended for service window applications. Mount up to 5 feet above the windowsill on interior of building.

2. SAFETY INFORMATION



WARNING

- To reduce the risk of fire, electric shock, or injury to persons, observe the following safety precautions:
- Use this product in the manner intended by the manufacturer. If you have any questions regarding the correct application and use, contact Ready-Access or a qualified representative. Disconnect power at electrical service panel prior to.
- Installation and electrical wiring are to be done by qualified personnel in accordance with the NEC and local codes.

3. INSTALLATION

Unpack MOUNTING BRACKET. MOUNTING BRACKET comes pre- assembled.

Verify that all parts and accessories are available and in the correct quantities.

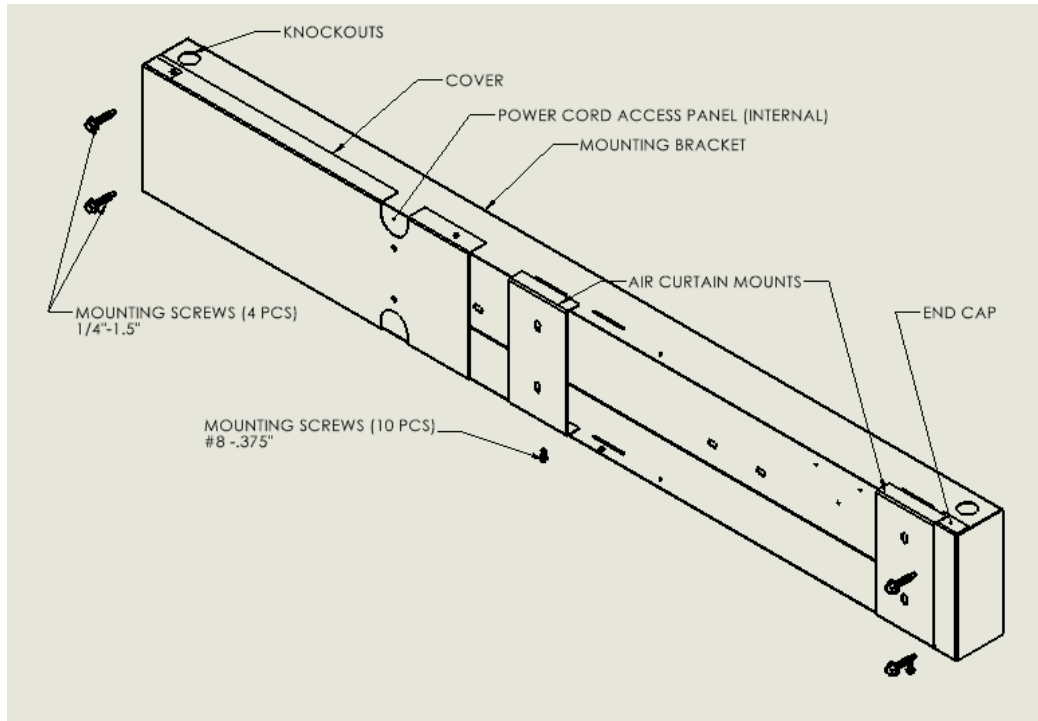

The bracket can be configured for right to left or left to right window opening.

Bracket configured for LEFT to RIGHT window. (As viewed from outside)

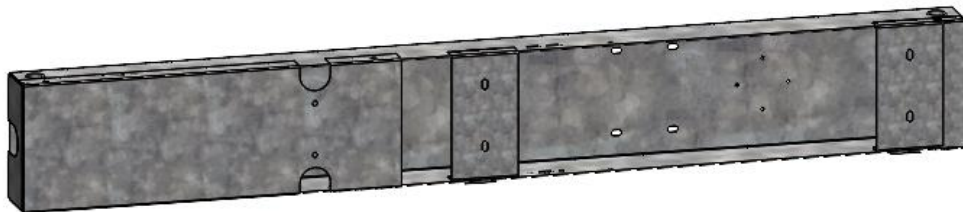

Bracket configured for RIGHT to LEFT



Dis-assemble mounting bracket and prepare for installation.

READY ACCESS INC. 1815 ARTHUR DRIVE WEST CHICAGO 60185 800-621-5045

www.ready-access.com email: ready@ready-access.com

Unpack SMALL MOUNTING BRACKET. MOUNTING BRACKET comes pre- assembled.

Verify that all parts and accessories are available and in the correct quantities.

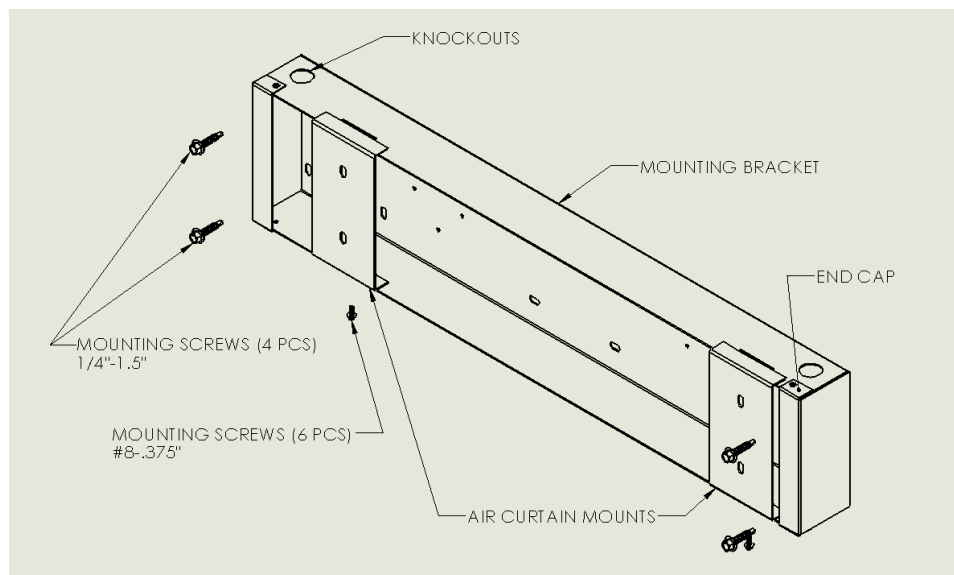

Mount the air curtain 36" to 60" above counter. If using on transom, recommended height is 44" above counter height – refer to the drawing below for mounting location.

Position on transom and mark screw holes on extrusion. Use (4) ¼ X 1-1/2inch long screws (included).

Alternatively, the mounting bracket can be mounted directly to a wall. (fasteners are not included for wall mount) Screw holes in mounting bracket are located on 16" centers for wall stud mounting.

Verify that the unit is level and secure.

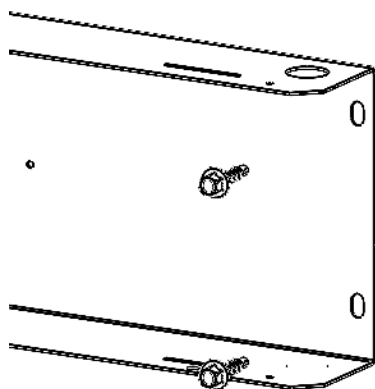

USE 4 PIECES OF ¼" SCREWS FOR
MOUNTING TO WINDOW EXTRUSION,
WALL MOUNT SCREWS NOT INCLUDED

Attach Mounting brackets to rear of RAC22 Air Curtain. Remove 2 screws from rear of air curtain and reuse screws to attach brackets.

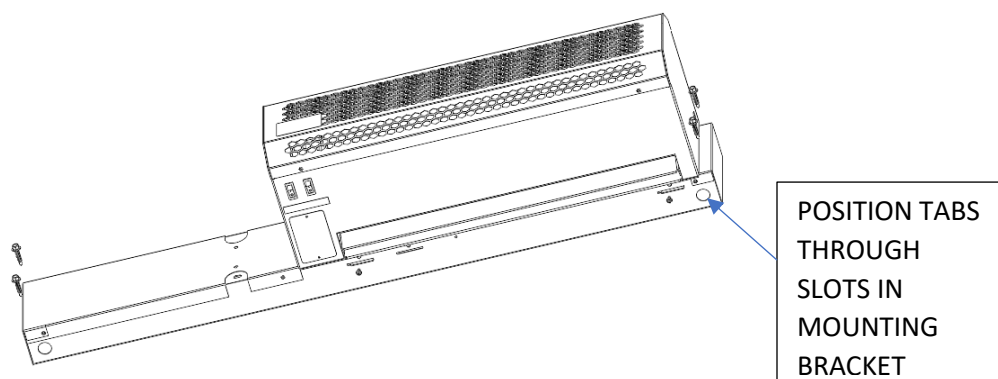
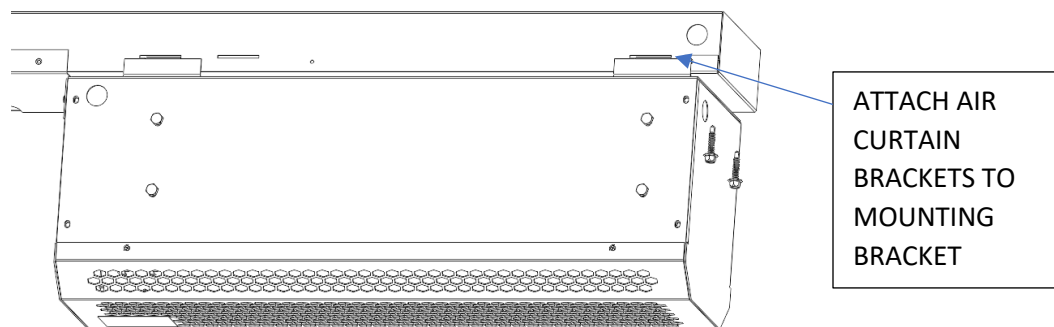
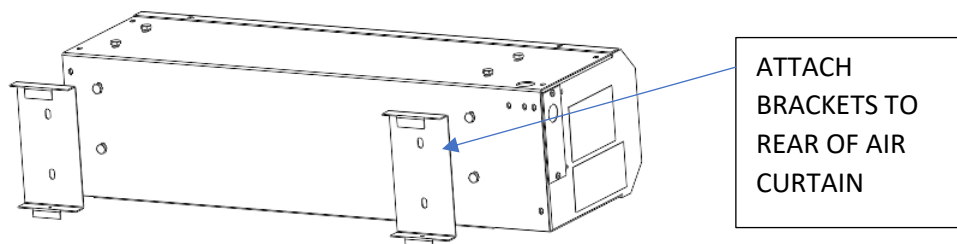

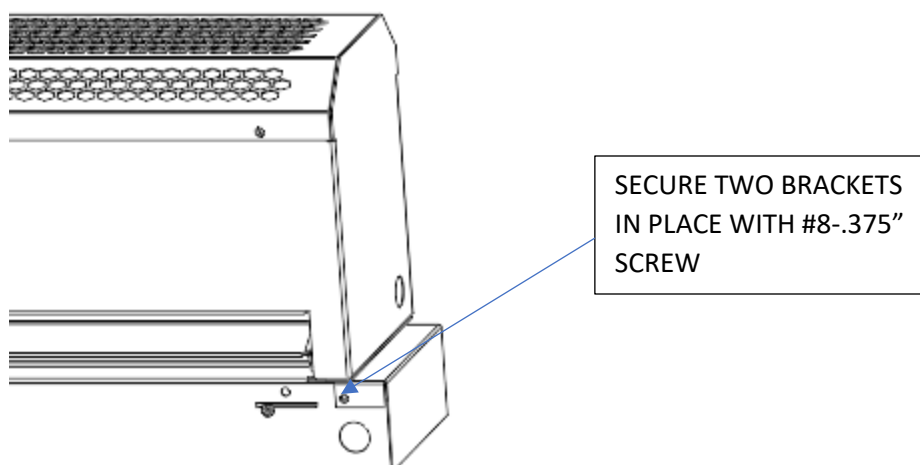

Reposition power cable hole cover to adapt to desired cable routing.

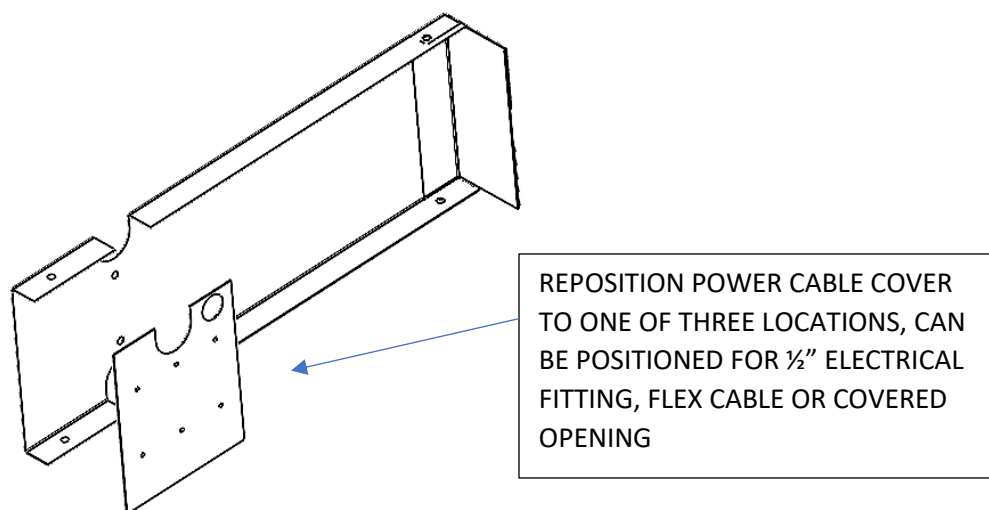

Re-install cover pieces for Left to Right or Right to Left configurations.

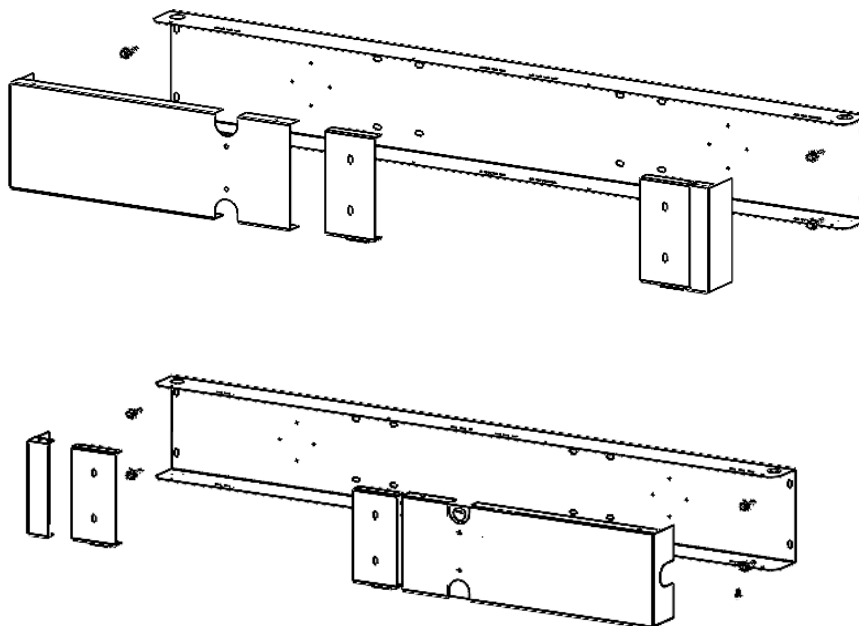

Small Mounting bracket.

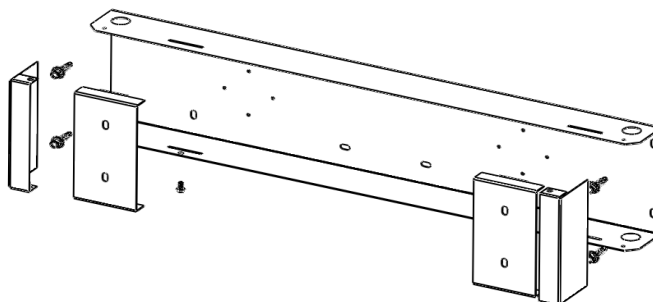

4. Optional installation of RELAY KIT

Refer to RELAY KIT installation instructions for wiring of relay kits.

Remove Mounting Bracket cover and RELAY electrical box cover. Use (2) #8 screws (included with relay kit) to attach electrical box to mounting bracket.

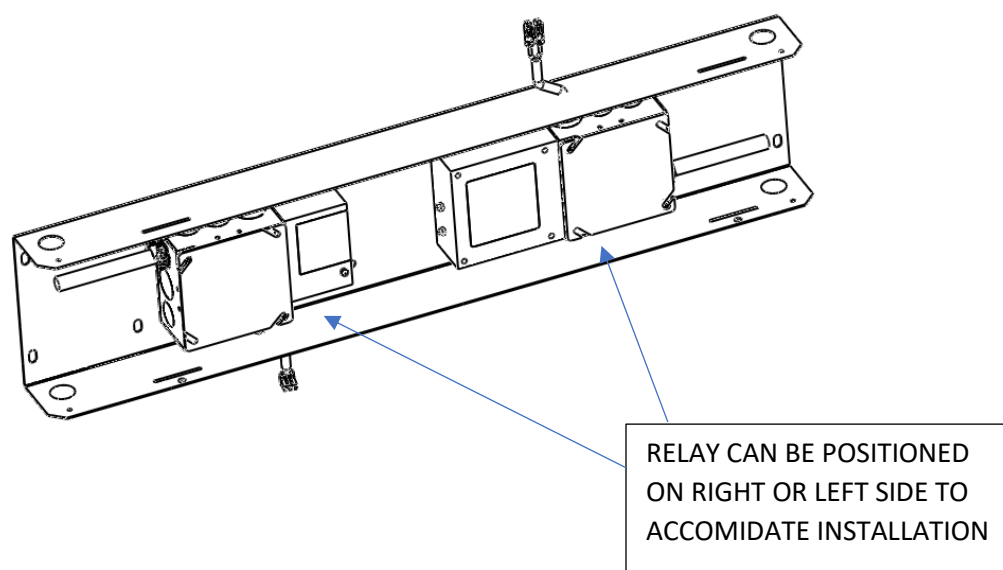
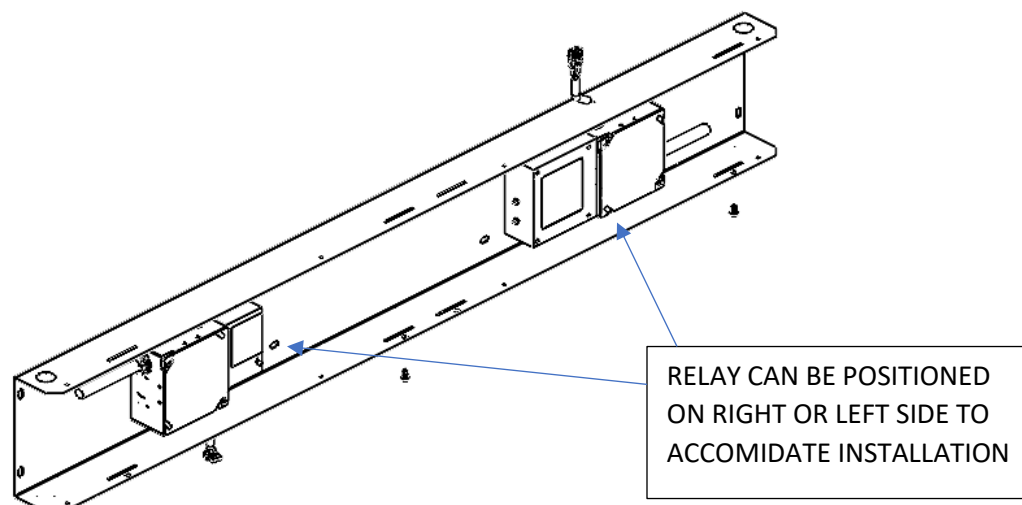

ELECTRICAL FIELD WIRING

The Unit must be wired per NEC and local codes.

Refer to rating label for correct voltage and ampacity.

Knockouts are provided for connection of ½" electrical connectors.

Field wiring can be completed with internal access through electrical access panel. Remove electrical access panel on left side of unit for access to and connection to internal wiring.

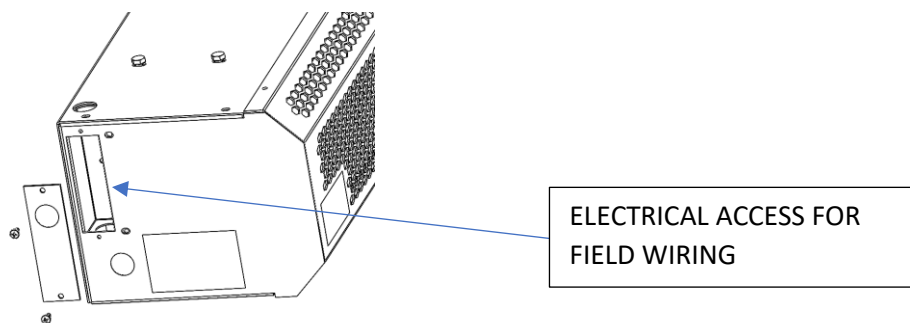

WARNING

To prevent hazard of electrical shock an electrical disconnect switch may be required to electrically disconnect this product.

Turn off circuit at breaker panel prior to wiring this item.

Use supply wires suitable for 60 degrees C.